



**Baker Library**  
541-523-6419



**Haines Library**  
541-856-3309



**Halfway Library**  
541-742-5279



**Huntington Library**  
541-869-2440



**Richland Library**  
541-893-6088



**Sumpter Library**  
541-894-2253



**Bookmobile**  
541-403-1390

## Library Closures\*

### Holidays

New Year's Day [Jan]

Birthday of M.L. King Jr. [Jan]

Presidents' Day [Feb]

Memorial Day [May]

Independence Day [Jul]

Labor Day [Sep]

Columbus Day [Oct]

Veterans Day [Nov]

Thanksgiving Day & day after [Nov]

Christmas Eve [Dec]

\*Closed early at 3PM

Christmas Day [Dec]



Wireless Internet  
available at all  
Baker Co. Libraries



Ask a  
Librarian



Chat or email at  
[answerland.org](http://answerland.org)

Or text the word "answers" and  
your question to **66746**.

*Helping you 24 hrs/day*



2400 Resort St  
Baker City, OR 97814

Phone: 541-523-6419

Fax: 541-523-9088

[www.bakerlib.org](http://www.bakerlib.org)



**Baker County  
Library District**

### BRANCH HOURS

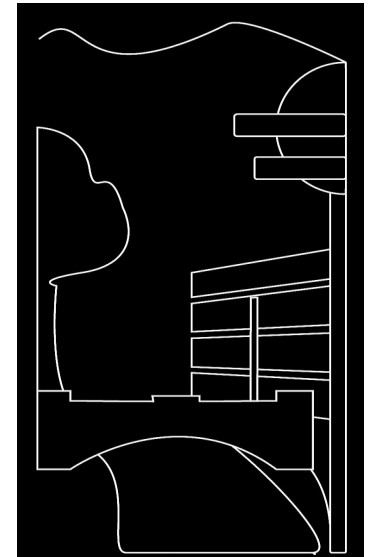

**Baker  
County  
Library  
District**

Tel. 541.523.6419  
Toll Free: 866.297.1239

[www.bakerlib.org](http://www.bakerlib.org)

# BAKER COUNTY LIBRARY DISTRICT: BRANCH HOURS

Last updated: 2019-09-07

	Sun	Mon	Tue	Wed	Thu	Fri	Sat
<b>BAKER CO. LIBRARY</b> 2400 RESORT ST BAKER CITY, OR 97814 541.523.6419 TOLL FREE 866.297.1239 FAX 541.523.9088 <a href="mailto:director@bakerlib.org">director@bakerlib.org</a>	<b>12:00-4 PM</b>	<b>9 AM - 7 PM</b>	<b>9 AM - 7 PM</b>	<b>9 AM - 7 PM</b>	<b>9 AM - 7 PM</b>	<b>9 AM - 6 PM</b>	<b>10 AM - 4 PM</b>
<b>HAINES LIBRARY</b> 818 COLE ST. HAINES, OR 97833  541.856.3309 <a href="mailto:haines@bakerlib.org">haines@bakerlib.org</a>			<b>10AM — 1 PM</b>		<b>10 — 1 PM</b>  <b>3:00 — 6:00 PM</b>	<b>1:00 — 4:00 PM</b>	<b>1PM — 4 PM</b>
<b>HALFWAY LIBRARY</b> PO BOX 922 / 260 GOVER LN HALFWAY, OR 97834  541.742.5279 <a href="mailto:halfway@bakerlib.org">halfway@bakerlib.org</a>			<b>1:00 — 4:00 PM</b>		<b>4 — 7 PM</b>	<b>9:00 AM — 4:00 PM</b> <small>&lt;CLOSED FOR LUNCH 12 — 1 PM &gt;</small>	<b>9 AM — 12 PM</b>
<b>HUNTINGTON LIBRARY</b> PO BOX 130 / 55 E JEFFERSON HUNTINGTON, OR 97907  541.869.2440 <a href="mailto:huntington@bakerlib.org">huntington@bakerlib.org</a>			<b>2:00 — 5:00 PM</b>	<b>4 — 7 PM</b>		<b>10:00 AM — 5:00 PM</b> <small>&lt;CLOSED FOR LUNCH 1—2 pm &gt;</small>	<b>10 AM — 1 PM</b>
<b>RICHLAND LIBRARY</b> 42008 MOODY ST RICHLAND, OR 97870  541.893.6088 <a href="mailto:richland@bakerlib.org">richland@bakerlib.org</a>		<b>10:00 AM — 2:00 PM</b>	<b>8 — 12 PM</b>			<b>10:00 AM — 2:00 PM</b>	<b>9 AM — 12 PM</b>
<b>SUMPTER LIBRARY</b> PO BOX 67 / 245 S MILL ST SUMPTER, OR 97877  541.894.2253 <a href="mailto:sumpter@bakerlib.org">sumpter@bakerlib.org</a>		<b>11 AM—3 PM</b> <small>(VOLUNTEER STAFF —OPEN AS AVAILABLE)</small>	<b>11 AM — 3 PM</b> <small>(VOLUNTEER STAFF —OPEN AS AVAILABLE)</small>	<b>3 — 6 PM</b>	<b>11AM — 3:00 PM</b>	<b>11AM — 3:00 PM</b>	<b>11AM — 3:00 PM</b>